

LINDNER



**KOMET 2200 HP | 2800 HP
STATIONARY SECONDARY SHREDDING**

**UNABASHEDLY
STRONG.**

ONLY LINDNER CLIENTS CAN TRULY SAY:

THAT'S HOW TO ACHIEVE UNPARALLELED THROUGHPUT.

GIVES YOUR PROCESSES A BOOST: MORE KNIVES, MORE EFFICIENCY.

The Lindner Komet HP is synonymous with high performance in secondary shredding. With an output 60% higher than the standard Komet series and two additional knife rows, the shredder guarantees enormous production capacities. High-precision electronics in combination with particularly robust housing components ensure the machine's enormous durability, even under the toughest conditions. And it produces consistently high-quality SRF – which is what the name Komet stands for.



1. HYDRAULIC MAINTENANCE DOOR

Remove non-shreddables quickly and cleanly with the maintenance door at position 2.

100% safe operation due to the mechanical safety lock and the pusher's special parking position.

Enjoy convenient maintenance access to the cutting chamber with the maintenance door at position 3.



2. HIGH-PERFORMANCE BELT DRIVE

More output with high-performance ABB motors.

High-precision electronics for precise drive control.

Efficient, stable and gearless belt drive.

Global availability of easily exchangeable standard parts.



3. TORQUE-LIMITING SAFETY CLUTCH

Complete drive protection thanks to the drive unit's instant mechanical disengagement.

Fully adjustable to various materials.

Secure power down with our proven sensors.

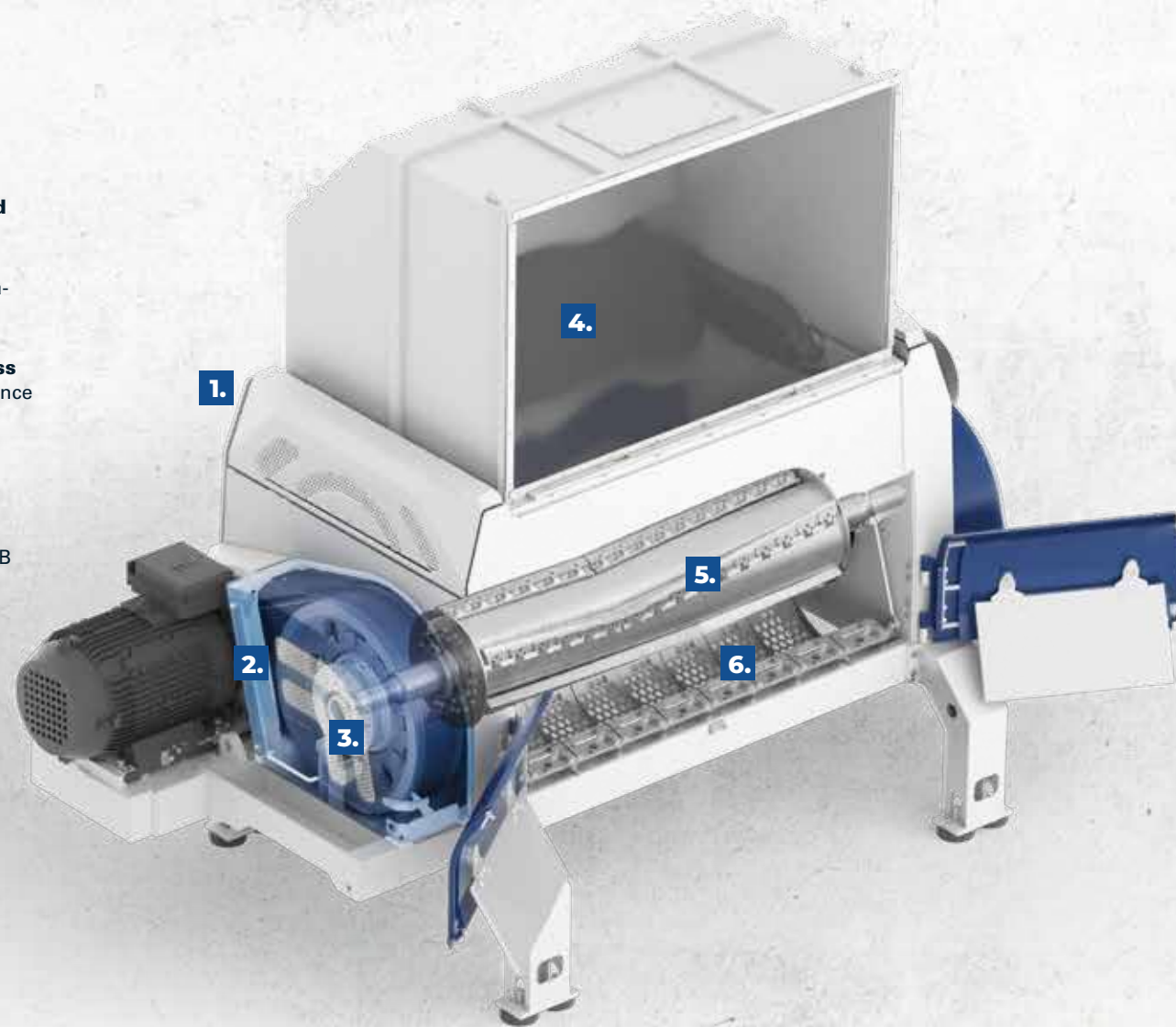

4. INTERNAL PUSHER

Continuous shredding due to smooth feeding.

Easy feeding with a completely internal construction.

Delightfully maintenance-free thanks to the absence of guide elements.



5. HIGH-PERFORMANCE SHEAR CUTTING SYSTEM

Seven rows of knives for over 5,000 cuts per minute.

Consistent particle size with a cutting gap fully adjustable even during operation.

Parts storage made easy thanks to identical knives, counter knives and scrapers.

Maximum service life ensured by quadruple-use, quick-change knives.



6. PLUG & GO SCREEN UNIT

Flexible output sizes made possible with screen units in various hole sizes..

Easy access for maintenance and fitting thanks to the swivel-mounted, hydraulically operated design.

Extremely safe operation with the electromagnetically locked screen access point, preventing access to the cutting chamber while the machine is in operation.



TECHNICAL DATA

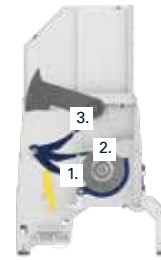
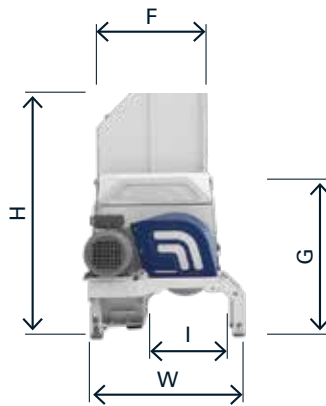
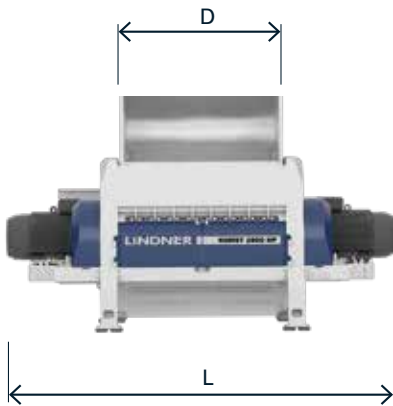

Hydraulic door for maintenance and removal of foreign objects

1. Operating position
2. Position for removal of foreign objects
3. Position for maintenance

KOMET 2200 HP

KOMET 2800 HP

DIMENSIONS*

Measure (LxWxH)	mm	5813 x 2925 x 3111	6827 x 2925 x 3111
Hopper opening (DxF)	mm	2135 x 2030	2825 x 2030
Capacity	m ³	4	5.3
Outlet width (I)	mm	960	960
Weight	kg	23200	29000

CUTTING UNIT*

Length	mm	2115	2805
Speed	min ⁻¹	355	367
Standard tool		blade knives 172R	blade knives 172R
Number of knives	pcs.	84	112
Screens		hexagonal/round	hexagonal/round
Number of screens	pcs.	6	8
Final output	mm	10–100	10–100

DRIVE UNIT*

Type		belt drive	belt drive
Motor	kW	2 x 200	2 x 250
Power control		frequency converter	frequency converter

*The stated values refer to standard machine versions with a standard hopper and raised feet. The right to make technical changes is reserved.



Atex explosion protection



Water sprinkling system



Fire extinguishing system
with spark detection



Cutting system cooling

Lindner-Recyclingtech GmbH

Villacher Strasse 48 | 9800 Spittal/Drau | Austria
t.: +43 4762 2742 | f.: +43 4762 2742-9032 | office@lindner.com

www.lindner.com